

## Revit Component Information Sheet

### OOOOH SYSTEMS™ STRAIGHT SECTION

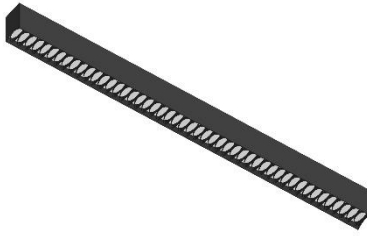

Manufacturer: **Beta-Calco Inc.**

File Name: **Lighting-Surface-Betacalco-Ooooh-Straight.rfa**

Family Category: **Lighting Fixtures**

Software: **Revit 2020**

IES: **Available**

Host: **Face \***

\* Face based (as opposed to ceiling or wall based) components can be recognized in both architectural and engineering Revit project files

Pre-loaded Type\*\*: **LE1PSL04-LV1-LPF030-CR80-CTA40-FA01**

\*\* Type names based on OOOOH SYSTEMS™ How to Order sheet

#### Instance Parameters:

**Length** – *input desired fixture length*

**Endcap A** – *select if section ends on this side*

**Endcap B** – *select if section ends on this side*

**Materials and Finishes**

**Electrical & Photometrics**